

NOTES: 1-SIZES MARKED WITH * ARE NOT AVAILABLE FROM RED HEAD AND ARE NOT COMMONLY USED IN NORTH AMERICA.
 2-HEADS ARE MARKED WITH INCH AND/OR METRIC STORZ SIZE.
 3-IF HEADS ARE UNMARKED, MEASURE LUG SPACING AND COMPARE.

STORZ SIZE		LUG SPACING	
INCH	METRIC	INCH	METRIC
1	25(D)	1.22	31
* -	32	-	44
1-1/2	38	2.00	51
* -	45	-	59
2	52(C)	2.60	66
2-1/2	65	3.19	81
3	75(B)	3.50	89
* -	90	-	105
4	100	4.53	115
* -	110(A)	-	133
5	125	5.83	148
6	150	6.30	160

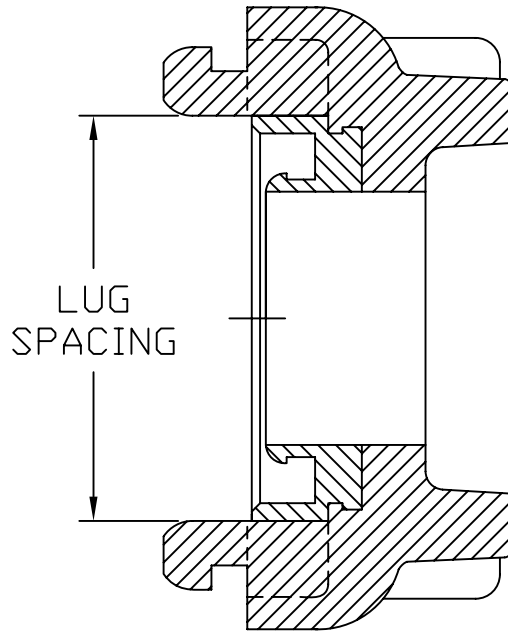

←-- 3 LUGS

TITLE **STORZ SIZES**

REV	DESCRIPTION	BY.	DATE
STYLE	MAT'L	FINISH	

UNLESS OTHERWISE SPECIFIED TOLERANCES TO BE:
 DECIMAL FRACTIONS
 X.XXX ± ±
 X.XX ±

Red Head **RED HEAD BRASS LLC.**
 SHREVE, OH.

SCALE FULL	DRAWN DATE J. CARROLL 02/26/09	APP'D DATE
------------	--------------------------------------	------------

THIS DRAWING IS THE PROPERTY OF RED HEAD BRASS LLC. AND THE CONTENTS HEREIN ARE PROPRIETARY AND CONFIDENTIAL. THE CONTENTS OF THIS DRAWING MAY NOT BE DISCLOSED OR USED BY ANYONE WITHOUT PRIOR WRITTEN CONSENT OF THE MANAGEMENT OF RED HEAD BRASS LLC. IT MAY NOT BE USED FOR MANUFACTURING UNLESS FULLY SIGNED.

DRAWING UNITS = INCHES
 ANGLES = ±
 125 ✓ ON ALL MACHINE SURFACES
 DO NOT SCALE DRAWING

DWG. NO.	STORZ SIZES	REV.
PART NUMBER		